

AGUAPURA® U.S.A. MODEL SW-1000

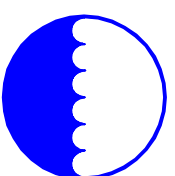

AGUAPURA® U.S.A.
 REVERSE OSMOSIS SYSTEMS
 SEA WATER DESALINATION

1000 GPD (42 GPH) POTABLE WATER PRODUCTION FROM SEAWATER WITH 36000PPM TDS AND 25C TEMPERATURE

LIST OF COMPONENTS

APPROX. OPERATING WT. = 140 POUNDS

1. PREFILTER – REPLACEABLE CARTRIDGE TYPE – 2.5" X 10" ELEMENT – CLEAR BOWL
 2. PLUNGER PUMP – "CAT PUMP CO." MODEL No. 2SF35SEEL (3.5 GPM – 870PSI) 316 STAINLESS STEEL PUMP MANIFOLD STANDARD
 3. 2 Hp MOTOR CLOSE COUPLE, DIRECT DRIVE – 1725RPM – 230V – 1 PHASE OR 3 PHASE – 60Hz.
 4. ONE (1) 1000PSI – 4" D X 40" L STAINLESS STL. PRESSURE VESSEL CONTAINING ONE (1) "HYDRANAUTICS" SWG5-LD4040 SEAWATER MEMBRANE .
 5. TWO (2) PRESSURE GAUGES–ALL STAINLESS STEEL–LIQUID FILLED– ONE 0–100PSI & ONE 0–1500PSI.
 6. NEEDLE VALVE 316 STAINLESS STEEL "PARKER" No. 4M-V4LN-SS.
 7. PULSATION DAMPER (HIGH PRESSURE FLEX HOSE) 1/2" X 24" LONG
 8. PRESSURE RELIEF VALVE (NOT SHOWN)
 9. LOW FEED WATER PRESSURE PROTECTION SWITCH WITH MOLDED FIBERGLASS/PLASTIC DIAPHRAGM BASE.
 10. ELECTRICAL POWER AND CONTROL BOX CONTAINING TIME DELAY RELAY AND CONTACTOR
- POTABLE WATER SEAWATER INLET
 3 WAY VALVE → 1/2" HOSE BARB
 POTABLE WATER 3/8" BARB VALVE W/ 2 3/8" BARB CONN.
 PRESSURE GAUGE
 NEEDLE VALVE 6
 CONCENTRATE OUTLET 3/8" BARB
 FIBERGLASS CHANNEL FRAME
 ELECTRIC CONTROL BOX 10
 3/4" ELBOW ATTACHED TO THE PLUG W/ 3/4" X 2" NIPPLE
 HIGH PRESSURE HOSE 1/2" X 32" LONG
 18.00"

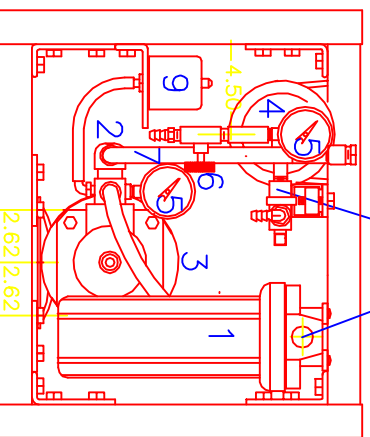

FRONT VIEW
 21.25"

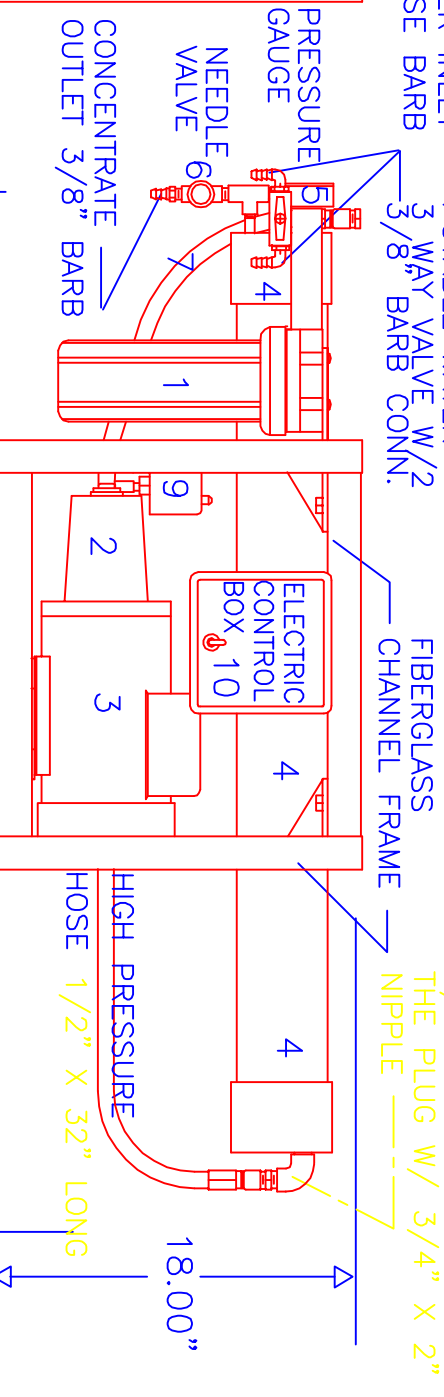

SIDE VIEW
 52.00"
 18.00"